

Redmond, WA 98053

Amesbury Homeowners Association
Architectural Control Committee

May 6, 2007

Dear ACC

RE: Construction of one Sport Court and landscaping. Clearing and leveling of upper backyard property. Installation and placement of Jacuzzi hot tub in lower backyard.

The purpose of letter is for the request approval for the placement of one 45' X 35' concrete sport court to be placed on property of 26205 NE 27th Dr. Lot #13.

Scope of work to be preformed.

- Item #1 Removal of one deceased large Maple tree and multiple cottonwood trees.
- Item #2 Excavate and level for 35 X 40 sport court and level lawn area.
- Item #3 Installation of concrete slab for sport court / place of in ground basketball goal (Goal unit to be used Goalrilla adjustable goal #1) .
- Item #4 Installation of 50' X 3' concrete block retaining wall with steps.
- Item #5 10ton of Basalt boulders to be placed through out the property as out cropping.
- Item #6 install of new lawn (hydroseed)
- Item #7 install of new trees, shrubs, mulch (Trees to be used evergreens, maples, birch and native shrubs)
- Item #8 install and extension of existing patio to accommodate a 7'X 7'5" Jacuzzi.

Landscape grade change: Upper portion of backyard to be leveled with an approximately three feet grade change.

Sport Court and landscape work to be done by AAA Concrete and All Pro Landscaping.

Placement of sport court: Upper Southeast corner of property seventeen feet from southeast corner of property and fifteen feet from east of property, grade change of approximately three feet.

Placement of Jacuzzi: On patio next to house, no gradechange.

Redmond, Washington 98053

May 2, 2007

RE: Construction of one 35' X 45' concrete Sport Court, placement of one 7'6" X 7' Jacuzzi and new landscaping through the back yard.

Dear Bruce,

Per the Amesbury Architectural Construction Committee, homeowners must seek the consent of the immediate adjacent neighbors for the construction of any new structures on their property. We will be placing a 35' x 45' sport court and a 7'6" x 7" Jacuzzi (along with other landscaping improvements) in our backyard. If you would like to see the drawings, we would be happy to provide those to you. Please confirm your consent to this new construction by signing below.

Sincerely,

I consent to the above construction,

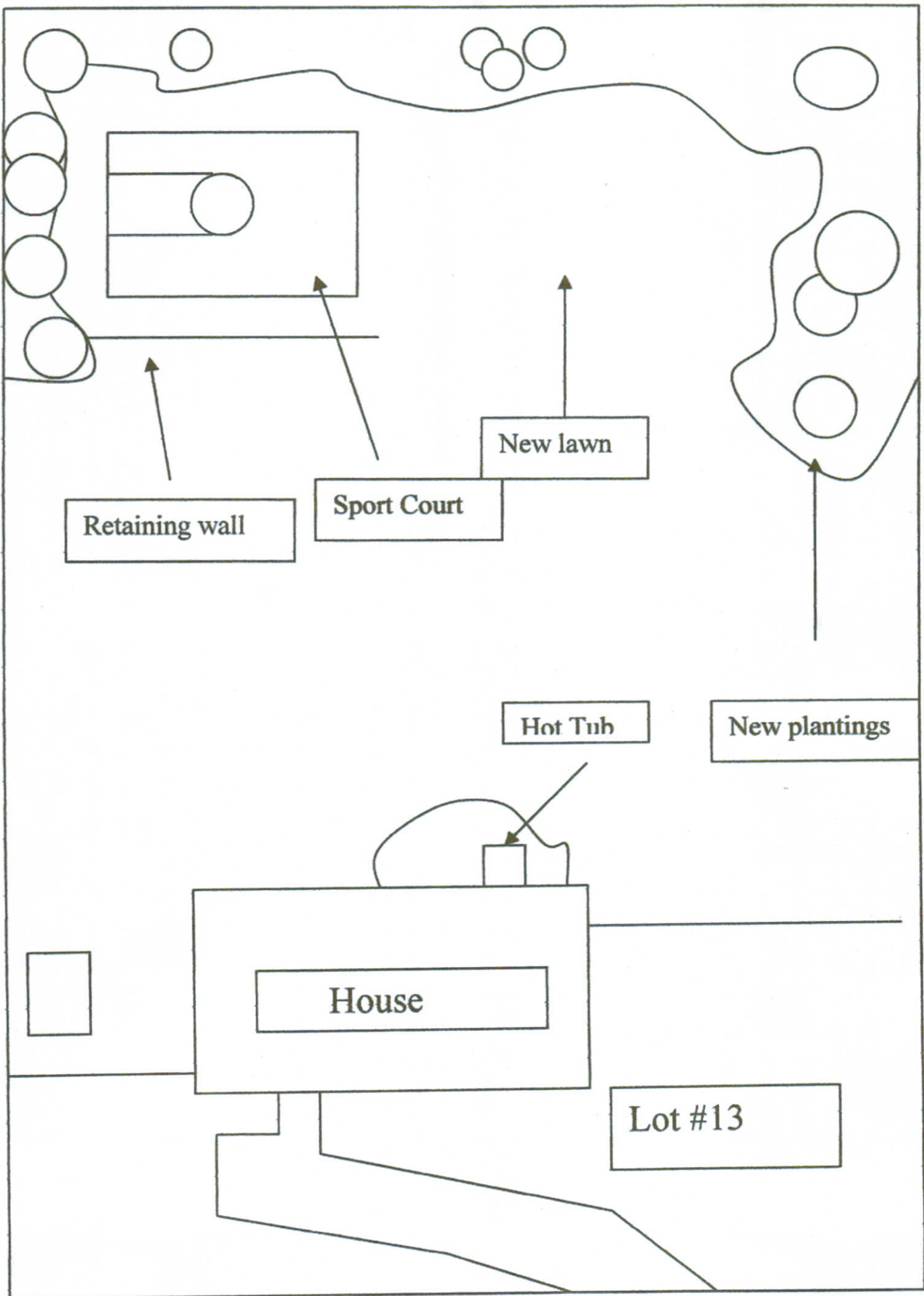

Retaining wall

Sport Court

New lawn

Hot Tub

New plantings

House

Lot #13